

FORM No. 1.

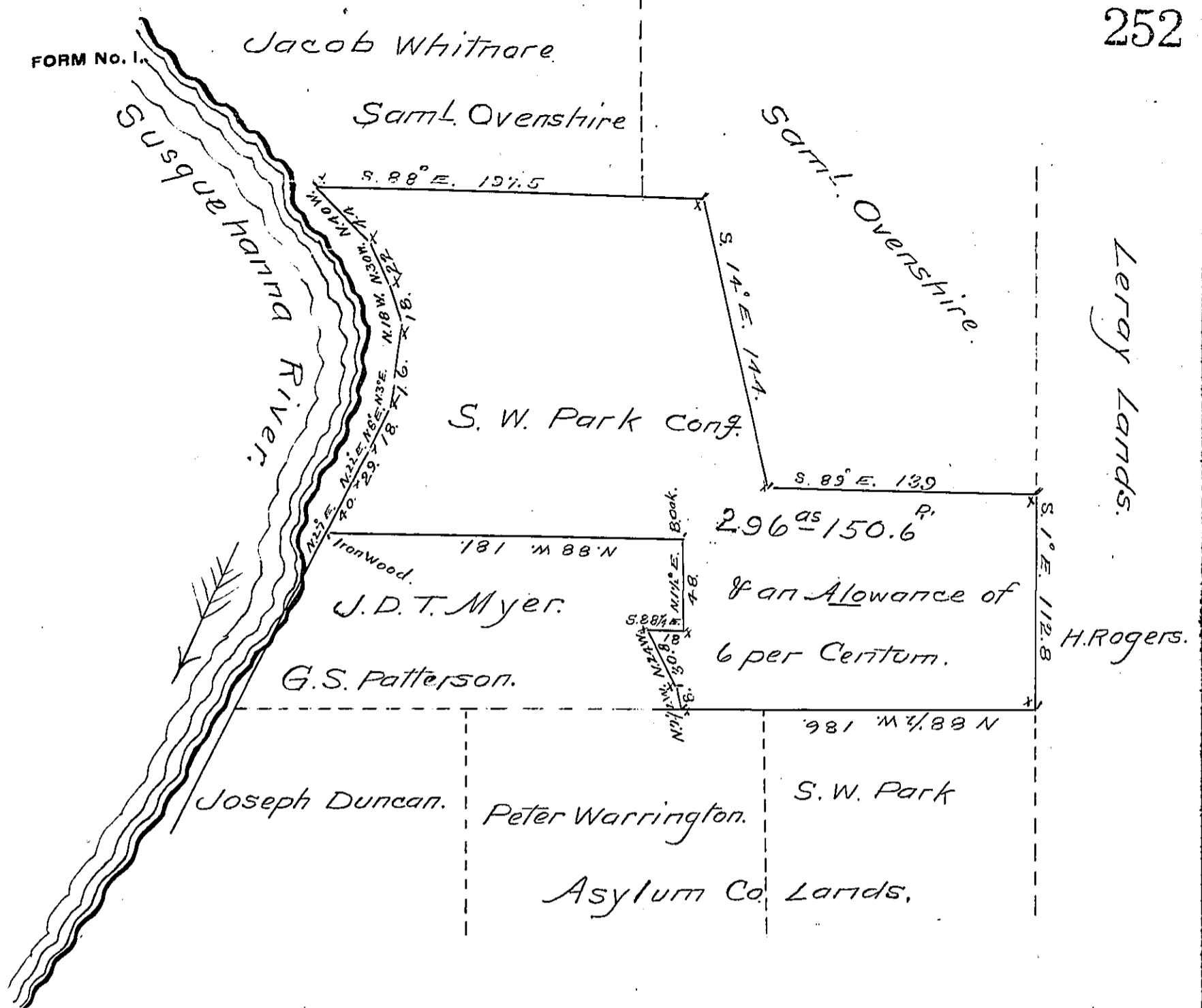

Draught of a Tract of land situate in Athens Township, Bradford County State of Pennsylvania containing two hundred & ninety six acres & one hundred & fifty & 6/10 perches & the allowance of 6 per Cent Surveyed February 19th. 1862. to Silas W. Park in persuance of a warrant dated Feb^y. 13th 1862.

To Henry Souther }
Surveyor General. }

J. J. Newell C.S.

Draft.

IN TESTIMONY that the above is a copy of the original remaining on file in the Department of Internal Affairs of Pennsylvania, made conformably to an Act of Assembly approved the 16th day of February, 1833, I have hereunto set my Hand and caused the Seal of said Department to be affixed at Harrisburg, this twelfth day of July 1906.

Luca B. Brown
Secretary of Internal Affairs